

Greater Pittsburgh Regional

TEAM EVENT HANDBOOK



PRESENTED BY

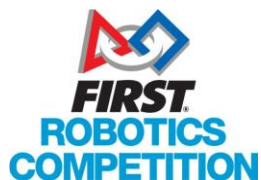

Table of Contents

Table of Contents	2
Welcome	3
COVID-19 Health and Safety Policy	4
Event Location	5
Directions	5
Parking	6
Load In/Load Out	8
Safety Glasses	9
Team Check-In	10
Contacting Other Teams	10
Team Pre-Order Meals	11
Team Onsite Meals	12
Lodging	13
Nearby Hardware / Supply Stores	13
Machine Shop	13
Practice Field	13
Reserved Seats for VIP's	14
Media Passes	14
Team Ambassadors	15
Volunteering	15
Dean's List and Chairman's Awards Signup	15
Safety Glasses	15
Participants of the 2022 Greater Pittsburgh Regional	16
Venue Floor Plan	17
2022 Greater Pittsburgh Regional Activity Schedule	18
Activities	19
Homework Study	19
Quiet Room	19
<i>FIRST</i> Ladies Meet-Up	19
A Tribute to Woodie Flowers	19
Scholarship Row	20
Mentor's Meeting	20
Mentor's Parade	20
<i>FIRST</i> LEGO League, Explore, <i>FIRST</i> LEGO League Challenge, and <i>FIRST</i> Tech Challenge Demonstrations	20
Mascot Parade	20
Senior Photo	20
T-Shirts	21
WiFi Availability	22
Event Rules Manual	22
Contact Us	22

Welcome

Welcome to the *FIRST*® Robotics Competition Greater Pittsburgh Regional Twentieth Anniversary Celebration!

We are delighted to have all of you - students, parents, teachers, sponsors, volunteers and spectators - with us for this special occasion, our twentieth year of the FIRST Robotics Competition in Western and Central Pennsylvania.

Greetings to our Greater Pittsburgh Regional teams and welcome to those who traveled long distances to be here with us! We look forward to seeing how you solved this year's *FIRST* Robotics Competition challenge, RAPID REACTSM presented by The Boeing Company. This week marks the culmination of months of hard work, creative problem solving and incredible team work. Here, on the arena floor, you will test your design, strategy and fabrication skills. You have learned what it means to be part of a team and you have contributed to its success. In the spirit of *Gracious Professionalism*®, your opponents will become your friends and colleagues – for years to come.

To all of our volunteers, mentors, teachers, and parents: Thank you for your year-round support to create this outstanding opportunity for our students. Your investment of time and energy has been significant, and you have served as terrific role models. You have positively impacted this next generation of innovators, educators, engineers and leaders and you should be proud of your accomplishments!

To all our sponsors and partners: you play a critical role thanks to your commitment of funding, volunteers, internships, and leadership. You know the importance of a workforce that is technically astute, innovative, and energized and recognize that *FIRST*® participants are the future workforce that keeps our country competitive in the global economy. And in these times of economic uncertainty, we are even more appreciative of those of you who have stepped up to help us continue this all-important event. This Regional and *FIRST* year-round STEM related activities have been made possible thanks to your support!

We invite everyone to join us to cheer for these students as they put into play lessons and skills learned over the past several months. Watch them compete on the arena floor and visit them in the pits. Talk to them and congratulate them! They are all winners! They are our future.

On behalf of the leadership of FIRST Western & Central, PA we wish all participating team members great success, volunteers amazing fun, and spectators super charged excitement! Best of luck to everyone!

The *FIRST*® Greater Pittsburgh Regional Planning Committee

COVID-19 Health and Safety Policy

Updated January 9, 2022, subject to change

FIRST is closely monitoring news and guidance from the Centers for Disease Control and Prevention, the World Health Organization, local health agencies, as well as state and federal laws and regulations, as we continue to plan the Greater Pittsburgh Regional. The following precautionary measures are currently in place for the event. These measures may be updated as new information becomes available.

Attendees refer to all participants, volunteers, staff, spectators, and guests.

- **Code of Conduct:** All attendees are expected to follow the [FIRST Code of Conduct](#), including demonstrating Gracious Professionalism at all times.
- **Event registration:** All attendees are required to register to attend the event either through volunteer registration, VIP invitation, CALU Staff, or through inclusion on the team's roster that indicates a signed Consent and Release agreement for each attendee.
- **Self-Evaluation:** All attendees are encouraged to perform a brief daily health self-evaluation to check for common symptoms of illness before entering the event. Attendees should not attend the event if they have symptoms of illness or have recently been in close contact with someone with symptoms of illness.
- **Face coverings:** Face coverings are required for all attendees and must be properly worn, covering the nose and mouth, in all indoor event areas. Attendees are asked to bring a sufficient supply of [suitable face coverings](#) for the duration of the event. A Face shield is not a suitable face covering.
- **Vaccination:** Vaccination greatly reduces the risks associated with COVID-19. We strongly recommend everyone who is eligible and has access to a vaccine consult with their physician and be fully vaccinated against COVID-19, with booster shots if applicable, prior to attending the event.
- **Social Distancing:** When possible, attendees are encouraged to practice social distancing and to remain in cohorts to limit interactions with those outside of their group. Attendees are expected to practice good hand hygiene. Please be mindful of high traffic areas such as the concession stands, seating areas, and the pit area. Be mindful to limit the number of attendees in the pit area to pit volunteers, those who are directly related to working on the robot, and their mentors. All other attendees are invited to enter the pits in short visits.
- **Safety Glasses:** *FIRST* volunteers will not distribute safety glasses to teams this year. Please bring an adequate supply of safety glasses for your team and attendees on your roster. Those without safety glasses are asked to enjoy the event in any areas where safety glasses are not required.

Event Location

**Convocation Center
California University of Pennsylvania
Riverview Drive
California, PA 15419 USA**

<https://www.calu.edu/convocation-center/index.html>

Directions

From the East (Harrisburg, Philadelphia):

Pennsylvania Turnpike to New Stanton Exit 75, Interstate 70 West to Exit 37A (Toll Road 43 South)**

From the Northeast (Scranton):

Interstate 81 South to Pennsylvania Turnpike, Pennsylvania Turnpike West to New Stanton Exit 75, Interstate 70 West to Exit 37A (Toll Road 43 South)**

From the North (Erie, Pittsburgh):

Interstate 79 South to Interstate 70 Exit, Interstate 70 East to Exit 37A (Toll Road 43 South)**

From the Southeast (Baltimore, Md., Washington, D.C.):

Interstate 70 West to Pennsylvania Turnpike, Pennsylvania Turnpike West to New Stanton Exit 75, Interstate 70 West to Exit 37A (Toll Road 43 South)**

From the West, Southwest (Ohio, West Virginia): Interstate 70 East to Exit 37A (Toll Road 43)**

****From Toll Road 43 South:**

Take the California Exit (bear right at end of exit). Stay straight toward Wood Street. Follow Wood Street down to intersection at Third Street (at stoplight). At stoplight, turn right onto Third Street and follow straight onto campus.

Parking

Parking is in the **River Lot**, which is marked with a **blue #4 star** on the map below.

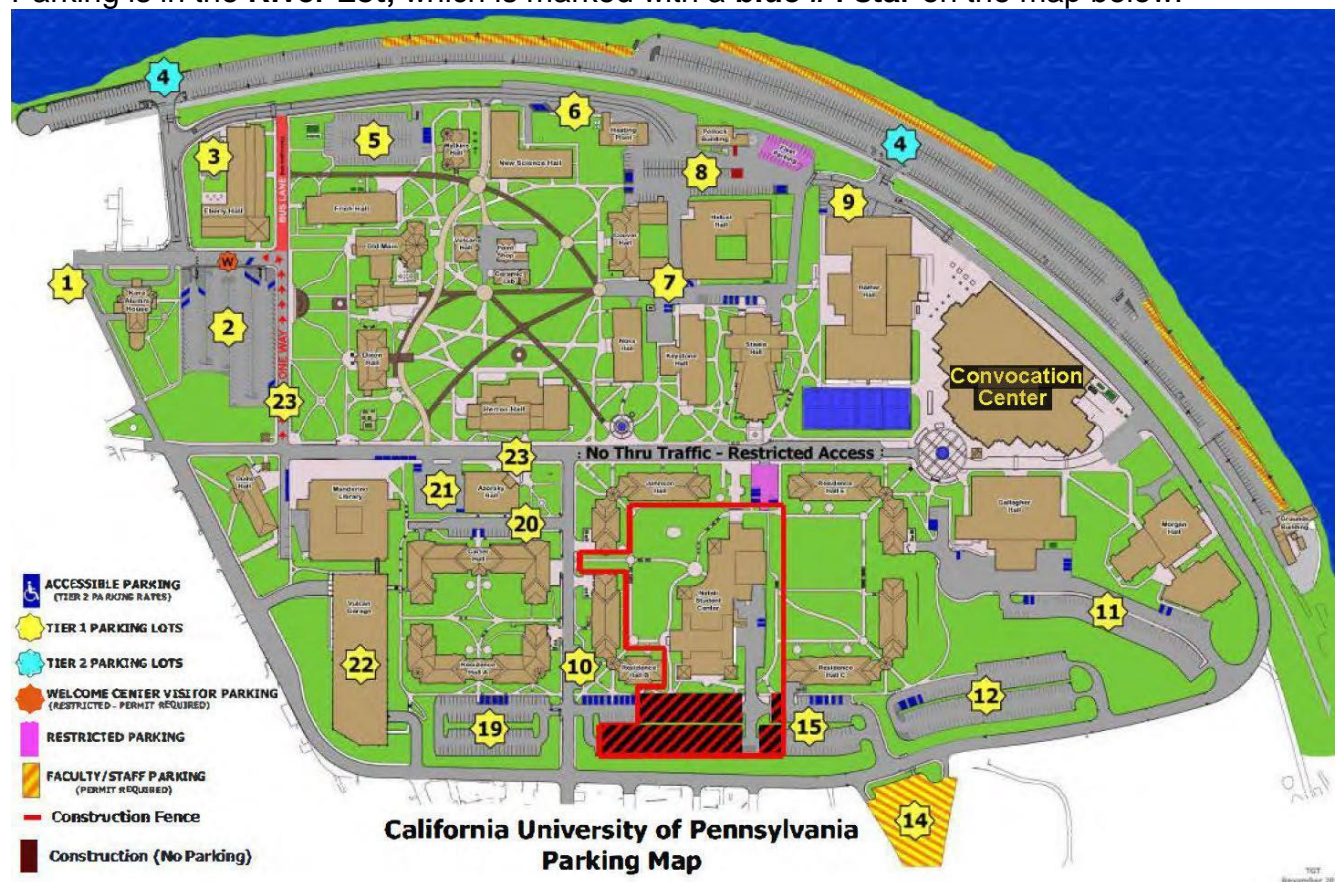

The main entrance for team members and visitors is at the cross-hatched circle on the map immediately to the lower left of the Convocation Center.

Accessible Parking (ADA) spots are identified on the map in dark blue. Lots 11 and 12 are the closest lots most likely to have available spots. The path is level between these lots and the Convocation Center.

Team and Visitor Parking: At Load-In, each team will receive one free parking pass which may be used in a specially marked area of the River Lot (#4 on the map above). The River Lot is best accessed by the entrance across from Lot 9. Buses, trailers, and oversized vehicles may not park in this lot. See Off-site Parking for buses and trailers.

Volunteer Parking: Parking for volunteers is in a specially marked area of the River Lot (#4 on the map above). The River Lot is best accessed by the entrance across from Lot 9. Volunteers will receive their free parking pass at check-in.

Off-site Parking for Buses and Trailers: The Philipsburg Trailer Parking area is available for additional parking and, in particular, is the best place for teams to park any buses, significantly-sized vehicles, or trailers used in transporting the team and equipment. Teams will not be permitted to unhitch and leave their trailers in lot 4A. Please see the map, below, for the preferred location of parking for busses and trailers. Signage on campus will be posted assist with teams locating appropriate parking for busses and trailers.



Load In/Load Out

Please remember your Gracious Professionalism® and be courteous to others who are trying to load-in or out as well.

Please follow the path of the arrows on the map for robot load-in and load-out. The loop is the best way to prevent curbside confusion and minimize the impact on one of Cal U's most heavily used roads.

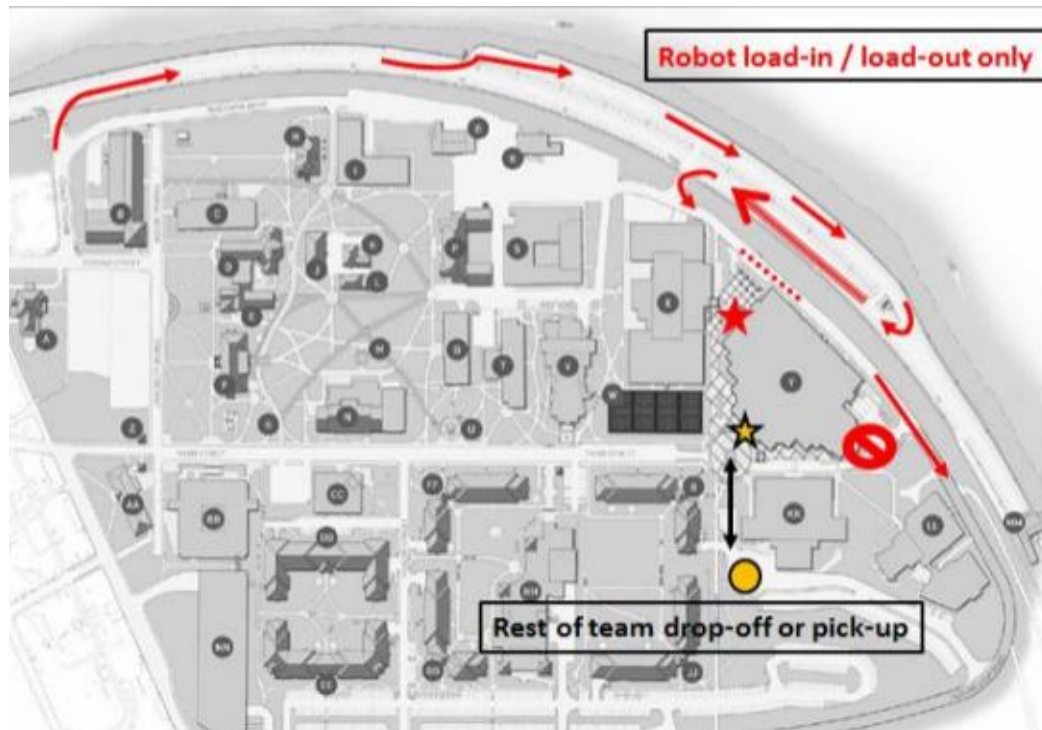

1. Enter the River Lot parking area from the Beazell Street entrance.
2. Continue along the parking lot until it widens and go down the left side that is closest to the river. Make a U turn at the end of the divided area and you will be in the main staging area (shown on the map as the wider line).
3. When the volunteer asks you to proceed, exit the parking lot and make the immediate left onto Riverview Drive.
4. You will be guided to park where the red dots are on the map to drop-off or pick-up your robot along with no more than the 5-member team.
5. To allow for faster unloading of team equipment, please unload all items to the courtyard (weather permitting) before moving them into the building.
6. Once unloaded, the vehicle should leave the Convocation Center area by staying on Riverview Drive. Do not turn right immediately after the Convocation Center as it leads to no outlet.

The rest of the team members and equipment should be dropped off or picked up at the Front of the Convocation center shown with the black and gold circle on the map. This minimizes the impact on the main road plus allows all the teams to collectively load-in and load-out faster. This area easily parks five large buses, offers easy turnaround space, and is safer. Team members can enter the Convocation Center at the main entrance marked by the black and gold star.

Vehicles may not remain curbside while teams set up their pits. The vehicle will need to be moved from the unloading zone to the River Parking Lot once it is unloaded. Only five members per team will be allowed in the Convocation Center for load-in. The standard *FIRST* safety rules will be in effect at the time of setting up the pit area. Please see the [2022 FIRST Robotics Competition Game Manual](#) for more information.

Teams are encouraged to use the Wednesday Evening load-in times, from 6:00 p.m. to 8:00 p.m. Teams that are unable to load-in Wednesday night may begin loading in their tools, materials, and robot through the Loading Area beginning Thursday morning, 7:45 a.m.

- Teams may only send in five people for load-in – remember safety glasses!
- At least one person must be an adult.
- Teams are encouraged to bring two adults as one adult needs to move the vehicle before loading in team materials.
- Please have all materials ready for load-in. Boxes, totes, etc. are much easier to move than individual items.
- Empty and move your vehicle prior to moving into the Convocation center.

During Load In, teams may begin to set up their pits and work on the robot. The venue closes promptly at 8:00 p.m.

We are able to offer Team Trailer/Truck parking this year. Please see the parking information below.

During Load-out, Teams will need to have all their materials ready to load before having their vehicle pull in for load-out. More information on the Load-Out procedures will be distributed at the event.

Safety Glasses

Remember to have your safety glasses handy when you load in Wednesday, not have them packed away. You will need them to get into the pits.

Safety glasses are required to be worn on and around the playing field and in the pit area per the 2022 Event Rules Manual. The pit area includes the walkway between individual pits. **FIRST volunteers will not distribute safety glasses to teams this year. Please bring an adequate supply of safety glasses for your team and visitors you invite.** Those without safety glasses are asked to enjoy the event in any areas where safety glasses are not required.

Team members will be allowed a 10-minute grace period to retrieve their safety glasses from their pits at the start of pit opening or load-in. Please note: This grace period is just to retrieve safety glasses. If robot work or pit set-up is being done, safety glasses must be worn, with no exceptions.

Team Check-In

ALL teams must submit their printed roster from Event Registration to ALL regional competitions that they attend.

- An adult member of your group, may check in the team, preferably the lead or alternate mentor.
- Team check-in is available Wednesday evening or Thursday morning when your team arrives.
- Please REMEMBER to bring a printed roster that includes all attendees who are associated with your team **indicating a Signed Consent and Release Agreement for each attendee.**
- Please include a phone number on the roster where the two lead adults of the team may be reached in the event of an emergency, such as a mobile number. Also please check that a voice mail may be left and the mailbox is not full.
- When submitting your roster, please cross off any names on the roster of individuals who will not be attending the event. Leave the names on the roster even if the attendees will be at the event for a portion of the total time, such Friday morning only.
- Double check that all names on the roster have completed the Consent & Release form electronically. This will be indicated by a check-mark to the far right of the name.
- Once the information is verified, we will count the number of adults and the number of youth for your group, and give the representative of your team wristbands to be worn at the event.
- Please be sure all attendees associated with your team wear the wrist bands for all days of the event.
- Wristbands will be checked throughout the event by Safety Attendants beginning 10:00 Thursday morning in order to give teams enough time to disburse the wrist bands to the members of the group.

Contacting Other Teams

Please take a look at two Facebook Pages that are a great way for you to communicate with other local teams and the teams who will be attending the Greater Pittsburgh Regional.

- [FIRST Western and Central PA Robotics](#)
- [The Steel City Robotics Alliance](#)

Team Pre-Order Meals

Teams may pre-order lunch meals directly from California University at:

<https://www.calu.edu/inside/events/robotics-lunch.jsp>.

All orders are due by 5:00 p.m., March 1, 2022.

FIRST Robotics Pre-Order Meal Options - California University of PA - March 17-19, 2022

ONLINE ORDERS ARE DUE BY: 5:00 p.m., MARCH 1st, 2022



Please visit the following link to order and pay online: <https://www.calu.edu/inside/events/robotics-lunch.jsp>

*Credit card purchases only **NO CHECKS and NO PAYMENTS WILL BE ACCEPTED ONSITE**

This year we are offering lunch pre-orders. In addition to the box meals we will also offer whole pizzas and Chick-fil-A. Please see the full list of selections being offered below. This is a helpful reference when ordering online.

	THURSDAY, March 17	FRIDAY, March 18	SATURDAY, March 19
LUNCH	<p>Box Meals \$9.75/ea: All sandwiches are garnished with leaf lettuce and tomato slice, whole fruit, potato chips, cookies, & bottle water.</p> <p>Option 1: Roast Turkey and Provolone Cheese served on baked roll</p> <p>Option 2: Fresh Honey Maple Ham and Swiss Cheese on baked roll</p> <p>Option 3: California Vegetarian on Sub Roll</p> <p>*Dietary requests can be made in the online order form</p> <p>18 inch Pizza (8 slices) Made fresh daily \$13.75 – Cheese Pizza \$15.70 – Pepperoni Pizza \$3.65 – 2 Liter Soda *selection made at pick up \$10.30 – Case of water (24 bottles)</p> <p>Chick-fil-A 200 count Chicken nuggets - \$96 Waffle Chips (Individual Bags) - \$1.99 Chick-fil-A Sweet tea - \$6.25/ gallon Chick-fil-A Unsweet Tea - \$6.25/gallon Chick-fil-A Lemonade - \$12/gallon Cookie Tray - \$18/per dozen</p>	<p>Box Meals \$9.75/ea: All sandwiches are garnished with leaf lettuce and tomato slice, whole fruit, potato chips, cookies, & bottle water.</p> <p>Option 1: Healthy Ones Sliced Chicken and Cheese on baked roll</p> <p>Option 2: Italian Grinder and Cheese served on baked roll</p> <p>Option 3: California Vegetarian on Sub Roll</p> <p>*Dietary requests can be made in the online order form</p> <p>18 inch Pizza (8 slices) Made fresh daily \$13.75 – Cheese Pizza \$15.70 – Pepperoni Pizza \$3.65 – 2 Liter Soda *selection made at pick up \$10.30 – Case of water (24 bottles)</p> <p>Chick-fil-A 200 count Chicken nuggets - \$96 Waffle Chips (Individual Bags) - \$1.99 Chick-fil-A Sweet tea - \$6.25/ gallon Chick-fil-A Unsweet Tea - \$6.25/gallon Chick-fil-A Lemonade - \$12/gallon Cookie Tray - \$18/per dozen</p>	<p>Box Meals \$9.75/ea: All sandwiches are garnished with leaf lettuce and tomato slice, whole fruit, potato chips, cookies, & bottle water.</p> <p>Option 1: Turkey and white American Cheese on a pretzel roll</p> <p>Option 2: Shaved Roast Beef with Cheese served on baked roll</p> <p>Option 3: California Vegetarian on Sub Roll</p> <p>*Dietary requests can be made in the online order form</p> <p>18 inch Pizza (8 slices) Made fresh daily \$13.75 – Cheese Pizza \$15.70 – Pepperoni Pizza \$3.65 – 2 Liter Soda *selection made at pick up \$10.30 – Case of water (24 bottles)</p> <p>Chick-fil-A 200 count Chicken nuggets - \$96 Waffle Chips (Individual Bags) - \$1.99 Chick-fil-A Sweet tea - \$6.25/ gallon Chick-fil-A Unsweet Tea - \$6.25/gallon Chick-fil-A Lemonade - \$12/gallon Cookie Tray - \$18/per dozen</p>

Team Onsite Meals

Onsite meals include the Concession Stand at the Convocation center as well as other reasonably priced food outlet options on campus. Cash and credit cards are accepted:

Concession Stand - Level 2, Convocation Center

<u>Thursday</u>	8:30 a.m. - 7:00 p.m.
<u>Friday</u>	8:00 a.m. - 7:00 p.m.
<u>Saturday</u>	8:00 a.m. - 5:00 p.m.

Modeco Coffee Roasters - Level 1, Natali Student Center

<u>Wednesday to Friday - Open daily</u>	8:00 a.m. - 4:00 p.m.
---	-----------------------

Chick-Fil-A - Level 1, Natali Student Center

<u>Wednesday to Saturday - Open daily</u>	10:30 a.m. - 5:00 p.m.
---	------------------------

Goldrush Dining Hall - Level 2, Natali Student Center

<u>Wednesday to Friday - Open daily</u>	7:30 a.m. - 8:00 p.m.
<u>Saturday - Open</u>	10:00 a.m. - 7:00 p.m.
Closed daily from 3:15 - 3:45 for refresh	

Umami - Level 2, Natali Student Center

<u>Wednesday to Friday - Open daily</u>	10:30 a.m. - 8:00 p.m.
---	------------------------

Natali Evening Eats - Level 2, Natali Student Center

<u>Wednesday to Friday - Open daily</u>	8:00 p.m. - 11:30 p.m.
<u>Saturday</u>	7:30 p.m. - 11:30 p.m.

Sycamore Bistro - Herron Rec Center

<u>Wednesday to Friday - Open daily</u>	7:00 a.m. - 6:00 p.m.
---	-----------------------

For more details on each outlet and menus please visit the dining services website:

<https://www.aviserves.com/calu/index.html>

Please note: **Outside food and drink are NOT allowed at the venue.** Likewise, no heat sources such as coffee pots, microwave ovens, etc., are allowed in the pits. Teams and visitors may purchase food at any of the reasonably priced venues shown above on campus to bring into the Convocation Center if desired.

Lodging

Many hotel accommodations are available nearby and may be found through an online search. This year, *FIRST* will not be booking blocks of rooms through Experient.

[The Hilton Garden Inn, Uniontown](#), has offered reasonable rates for those who need rooms. The rate includes breakfast for up to 4 people per room. Click on the link for the unpublished price.

Nearby Hardware / Supply Stores

Brownsville Do it Best Hardware

3.1 miles
Grindstone, PA
(724) 785-4100

Coulson's Sales & Service

5.0 miles
Belle Vernon, PA
(724) 929-6535

Lowe's Home Improvement

3.4 miles
Belle Vernon, PA
(724) 930-7000

Williams Ace Hardware

5.0 miles
West Newton, PA
(724) 872-7783

Tractor Supply Co.

3.9 miles
Belle Vernon, PA
(724) 929-5200

Machine Shop

The machine shop is located in the Helsel building with staff onsite to help you with your machining needs. The shop is created for quick fixes and repairs. The Helsel building is located on the campus map between parking lot 7 & 8. Signs will be posted directing teams to the Helsel building at the event.

Practice Field

A full practice field is located on the loading dock of the Convocation center. The field will be available on a first-come, first-served basis.

Reserved Seats for VIP's

Reserved seats in mid-field are intended for VIP seating to have a view of the competition field. This area will be used by the Judges during opening and closing ceremonies. A few other seats will be reserved for Judge Match Observers. Please respect the judge seating reservations.

No other seats may be saved at any time. Seat saving devices will be removed.

Media Passes

Team Media – 2022 *FIRST* Robotics Competition - Greater Pittsburgh Regional

- The team will be issued one media badge at the beginning of the competition. The team will not be given a 2nd or a replacement badge.
- The Team Media person **MUST** queue up with the team. The badge must be visible.
- The Team Media person may move about the perimeter of the field outside of the carpet, except for the section in front of the scorekeepers when the team is on the playing field.
- The Team Media person is asked to be mindful of others, to keep out of the way of traffic, or may be asked to leave the area.
- The Team Media person may not coach others.
- The Team Media person is asked to please be mindful that Referees need to see the field and will move around the field.
- The Team Media person needs to leave the area immediately following the match.
- If rules are not followed, the removal of a badge may be determined by the Head Referee or FTA.

We are asking each Team Media Person to submit 20 or so of their best images by 8:00 a.m. Saturday morning. Email the Regional Director at dfrownfelter@firstinspires.org.

Identify your images with your team number.

These images may be selected for use by *FIRST* for a slide show Saturday, so be creative! Variety and creativity are important, and we are truly looking forward to seeing your team images.

Team Ambassadors

If your team has students who would be great at talking with people, please have them sign up at Pit Admin. Each Ambassador will have a name tag with an Ambassador ribbon attached. The Ambassadors will take our VIP's and other guests on tours of the pits and should be prepared to answer questions about themselves, their team, and this year's competition. The Ambassador's welcome table will be located in the front entry on Friday and Saturday. Students will staff the table in shifts and won't be on duty for the whole competition.

Volunteering

Volunteering at the Greater Pittsburgh Regional is a great way to get to know the details of the FIRST Robotics Competition. Simply follow the prompts on your firstinspires.org dashboard and register. Many positions are available for those who may be arriving with a team Thursday morning. While we ask volunteers to be available for Thursday, Friday, and Saturday and Judges to be available Friday and Saturday, day positions are also available. When registering, please specify the day(s) you are available, or add a note to the comment section specifying that you would like to participate for only one day, but have no preference of which day. Come and join the fun.

Dean's List and Chairman's Awards Signup

Sign-up sheets with prescheduled team and student time slots for the Dean's List and Chairman's Awards will be available at Pit Admin. beginning Thursday noon. Time slots may be switched with another team or individual with agreement by both parties. See Pit Admin for details.

Safety Glasses

Safety glasses are required to be worn on and around the playing field and in the pit area per the 2020 Event Rules Manual. The pit area includes the walkway between individual pits. **FIRST volunteers will not distribute safety glasses to teams this year. Please bring an adequate supply of safety glasses for your team and visitors you invite.** Those without safety glasses are asked to enjoy the event in any areas where safety glasses are not required.

Team members will be allowed a 10-minute grace period to retrieve their safety glasses from their pits at the start of pit opening or load-in. Please note: This grace period is just to retrieve safety glasses. If robot work or pit set-up is being done, safety glasses must be worn, with no exceptions.

Participants of the 2022 Greater Pittsburgh Regional

Team Number	Team Name	Location
27	Team RUSH	Clarkston, Michigan, USA
117	Steel Dragons Robotics	Pittsburgh, Pennsylvania, USA
120	Cleveland's Team	Columbus, Ohio, USA
144	The R.O.C.K	Cincinnati, Ohio, USA
156	RPM - Robotics Plus Mayhem	Fairview, Pennsylvania, USA
291	CIA - Creativity In Action	Erie, Pennsylvania, USA
302	The Dragons	Lake Orion, Michigan, USA
325	Respawn Robotics	Hamilton, Ohio, USA
337	Hard Working Hard Hats	Logan, West Virginia, USA
378	The Circuit Stompers	Newfane, New York, USA
379	The RoboCats	Girard, Ohio, USA
554	The Bluegrease Crew	Fort Thomas, Kentucky, USA
695	Bison Robotics	Beachwood, Ohio, USA
1511	Rolling Thunder	Penfield, New York, USA
1708	AMP'D Robotics	McKeesport, Pennsylvania, USA
1743	Short Circuits	Pittsburgh, Pennsylvania, USA
1787	Flying Circuits	Pepper Pike, Ohio, USA
2051	The Beattie Bulldogs	Allison Park, Pennsylvania, USA
2053	Southern Tier Robotics	Vestal, New York, USA
2252	The Mavericks	Milan, Ohio, USA
2603	Steel Stingers	Medina, Ohio, USA
2614	Mountaineer Area Robotics (MARS)	Morgantown, West Virginia, USA
2641	PCCR	Pittsburgh, Pennsylvania, USA
2656	Quasics	Monroeville, Pennsylvania, USA
3201	Ross Rambotics	Hamilton, Ohio, USA
3260	SHARP	Pittsburgh, Pennsylvania, USA
3504	Girls of Steel	Pittsburgh, Pennsylvania, USA
3539	The Byting Bulldogs	Romeo, Michigan, USA
3814	PiBotics	Erlanger, Kentucky, USA
3954	4-H Electrotechs	Emlenton, Pennsylvania, USA
4027	Centre Punch	State College, Pennsylvania, USA
4050	Biohazard	Chambersburg, Pennsylvania, USA
4085	Technical Difficulties	Reynoldsburg, Ohio, USA
4145	WorBots	Columbus, Ohio, USA
4150	FRobotics	Murrysville, Pennsylvania, USA
4269	CardinalBots	Columbus, Ohio, USA
4467	Titanium Titans	Canonsburg, Pennsylvania, USA
4547	WestyTek Robotics	Johnstown, Pennsylvania, USA
4991	Horsepower	Bridgeville, Pennsylvania, USA
5492	Winner's Circle Robo Jockeys	Louisville, Kentucky, USA
5740	Trojanators	Cranberry Township, Pennsylvania, USA
5842	Royal Robotics	New Port Richey, Florida, USA
6032	Pirate Robotics	Dayton, Ohio, USA
6834	Bionic Warriors	Pataskala, Ohio, USA
7165	Perkins Pirates	Sandusky, Ohio, USA
7274	Brashear Bulls Robotics	Pittsburgh, Pennsylvania, USA
7460	Avi and Friends	Sylvania, Ohio, USA
7515	Dark Side Robotics	Parkersburg, West Virginia, USA
8027	Not the Droids You Are Looking For	Sharon, Pennsylvania, USA
8705	Sci-Tech FRC	Pittsburgh, Pennsylvania, USA

Venue Floor Plan

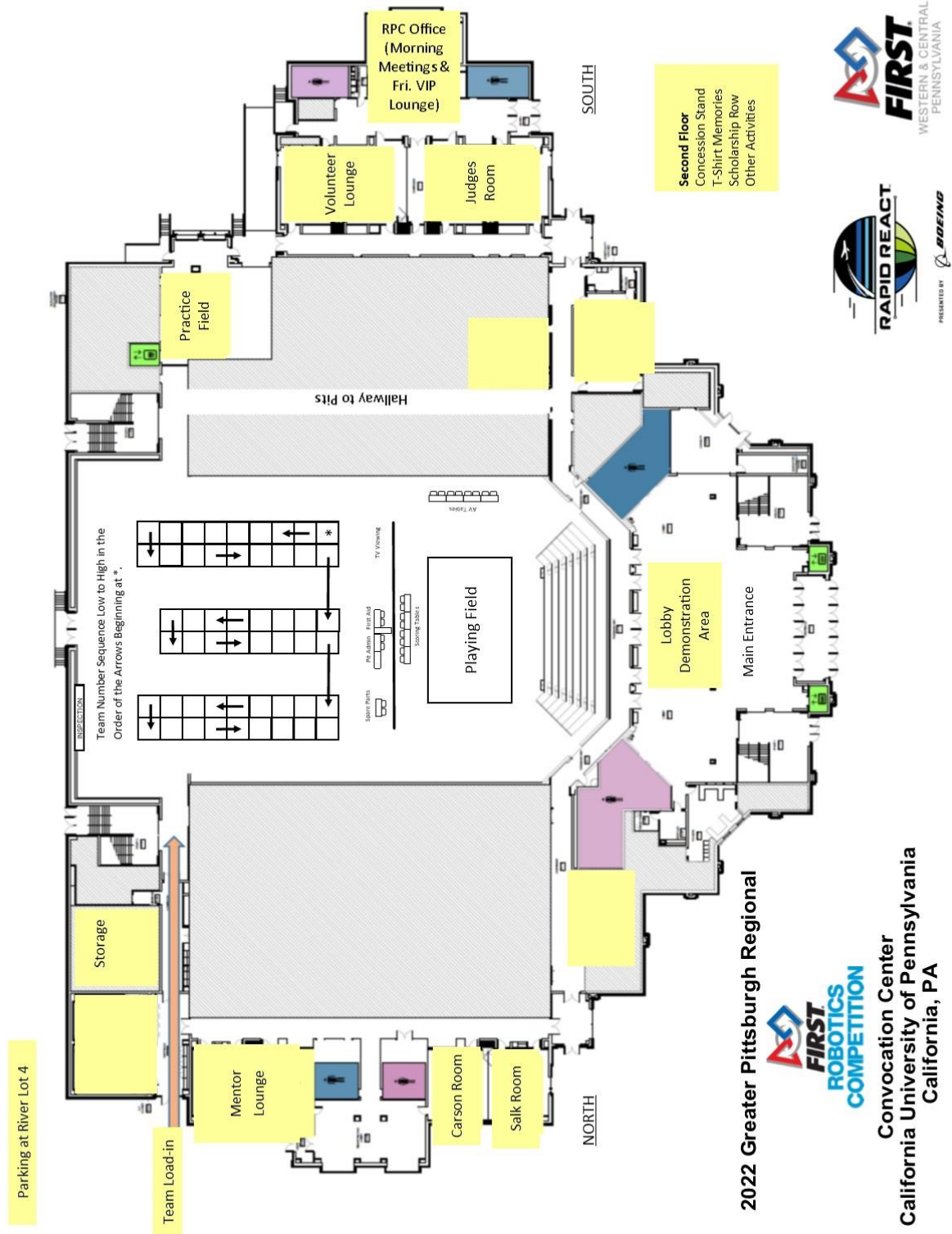

2022 Greater Pittsburgh Regional Activity Schedule

Competition Schedule

Wednesday	
6:00PM-8:00PM	5 Team Reps to Load In and Set Up Pits

Thursday	
7:45AM	5 Team Reps to Load In
8:30AM	Pits, Machine Shop, Registration and Inspection Open
9:00AM-11:00AM	Driver's Meeting, Field Open for Measurement and Calibration
11:00AM-12:00PM	Lunch
12:00PM-6:30PM	Practice Matches
8:00PM	Pits and Machine Shop Close Teams exit the building

Friday	
8:00AM	Pits and Machine Shop Open
8:30AM-9:00AM	Opening Ceremony
9:00AM-12:00PM	Qualification Matches
12:00PM-1:00PM	Lunch
1:00PM-5:45PM	Qualification Matches
5:45PM-6:15PM	Awards Ceremony
6:30PM**	Pits and Machine Shop Close Immediately Following Awards Ceremony. Teams exit the building.

Saturday	
8:00AM	Pits and Machine Shop Open
8:30AM-9:00AM	Opening Ceremony
9:00AM-12:15PM	Qualification Matches
12:15PM-12:30PM	Alliance Selections
12:30PM-1:30PM	Lunch
1:30PM-4:30PM	Playoff Matches
4:30PM-6:00PM	Awards Ceremony
6:30PM	Pits and Machine Shop Close Immediately Following Awards Ceremony. Teams exit the building.

Team Activities Schedule

Thursday	
8:30AM-4:00PM	Homework Study, Mentor's Lounge
9:00AM-1:00PM	Scholarship Row, 2nd Floor
11:00AM-12:00PM	<i>FIRST</i> Ladies Meet-Up, Mentor's Lounge

Friday	
8:00AM-6:30PM	T-Shirt Memories, 2nd Floor
11:00AM-3:00PM	Scholarship Row, 2nd Floor
12:15PM-1:00PM	Mentor's Meeting, Mentor's Lounge, Bring your Lunch
5:40PM	Mentor's Parade, Playing Field

Saturday	
8:00AM-6:30PM	T-Shirt Memories, 2nd Floor
10:00AM-12:00PM	<i>FIRST</i> LEGO League Explore, <i>FIRST</i> LEGO League Challenge, and <i>FIRST</i> Tech Challenge Demonstration, Lobby
10:00AM-1:00PM	Scholarship Row, 2nd Floor
12:10PM-12:15PM	Mascot Parade, Playing Field
12:30PM	Senior Photo, Playing Field

****Schedule subject to change.** All times are estimated based on flow of rounds. See Pit Administration table for updated times.

A Quiet Room is available. See Pit Admin if a quiet room is desired.

Activities

Homework Study

We understand your sacrifice as a student to be at *FIRST* Robotics Competitions during school hours, and realize your efforts to juggle your schedules. The Mentor's Lounge will be available for students to use to study Thursday, 8:30 a.m. to 4:00 p.m. (with a time-out for the *FIRST* Ladies Meet-Up from 11:00 a.m. to 12:00 p.m.). Please use Gracious Professionalism in the Homework Study as students need a quiet place to work on their assignments.

Quiet Room

The Quiet Room has been created to be a quiet, relaxing space intended to help team members with lower sensory limits to unwind from the competition. Please see Pit Admin if a quiet room is desired.

FIRST Ladies Meet-Up

Team 3504, Girls of Steel, is hosting the *FIRST* Ladies Meet-up in the Mentor's Lounge, Thursday, 11:00 a.m. - 12:00 p.m. All are invited to attend a discussion with presentations of teams attending the Greater Pittsburgh Regional. Please contact the Girls of Steel at girlsofsteelrobotics@gmail.com for more information if you are interested in being a presenter.

A Tribute to Woodie Flowers

A full-size color cutout of Woodie, wearing his famous signature denim shirt will be displayed at the Regional. To carry out the tradition of Woodie's shirt signing, a denim shirt will be near the cutout for YOU to sign. Once you sign the shirt, you are committing to carry on Gracious Professionalism in all that you do. Woodie loved to talk to you and share your excitement for *FIRST*, but more importantly he wanted you to get the most out of the *FIRST* experience by behaving as though your Grandmother was watching! We hope that by signing the shirt you will honor the legacy that Woodie established.

Scholarship Row

Please join us at Scholarship row on the second floor of the Convocation center. More than \$80 million of scholarship funds is available to *FIRST* members. Meet some of the colleges who offer these scholarships as well as gather information on other scholarship opportunities. Days and times may be found on the schedule.

Mentor's Meeting

The Mentor's Meeting is scheduled for Friday, 12:15 p.m. to 1:00 p.m. in the Mentor's Lounge. Tables will be available for you to bring your lunch for a "Town Hall" meeting. Mentors, coaches, and parents of all teams are welcome to attend.

Mentor's Parade

The Mentor's Parade is scheduled for Friday, around 5:40 p.m., around the playing field between Qualification Matches and the Awards Ceremony.

FIRST LEGO League, Explore, *FIRST* LEGO League Challenge, and *FIRST* Tech Challenge Demonstrations

Area teams from *FIRST* LEGO League Explore, *FIRST* LEGO League Challenge, and *FIRST* Tech Challenge will host a demonstration of this season's robots in the Lobby of the Convocation Center, Saturday, 10:00 a.m. to 12:00 p.m. After the demonstration they are invited to join the fun, walk through the pits, and watch the rest of the event. We welcome these teams to see what we do in the *FIRST* Robotics Competition.

Mascot Parade

The Mascot Parade is scheduled for Saturday around 12:10 p.m., around the playing field between Qualification Matches and Alliance Selections.

Senior Photo

The Senior Photo will be taken soon after Alliance Selections Saturday around 12:30 p.m., on the playing field.

T-Shirts

T-Shirts and other event apparel will be available on the second floor of the convocation center.

Fine Designs
IMPRINTED SPORTSWEAR

**APPAREL AS
UNIQUE AS YOU!**

CREATE MEMORIES WITH CUSTOM APPAREL

3 SIMPLE STEPS

1. CHOOSE THE SHIRT
2. CHOOSE THE SIZE
3. CHOOSE THE LOGOS TO CUSTOMIZE

Get your shirts at the event!

RAPID REACT
PRESENTED BY **BOEING**
2022 GREATER PITTSBURGH REGIONAL

NEVER GIVE UP

**DON'T MISS OUT ON
YOUR ORIGINAL APPAREL!**

Fine Designs Imprinted Sportswear
Fine Designs is a proud sponsor and official event merchandiser ©2022 Fine Designs Inc.

WiFi Availability

Wifi will be available for participant use. While interference hasn't been an issue in past events, wifi availability may be discontinued in the event that wifi use interferes with field communication.

Per the 2022 Event Rules Manual:

Teams may not set up their own 802.11a/b/g/n/ac/ax (2.4GHz or 5GHz) wireless communication (e.g. access points or ad-hoc networks) in the venue.

Participants may not interfere, attempt to interfere, or attempt to connect with any other team or *FIRST* wireless communication except as expressly allowed for purposes of communicating with their team's ROBOT on the FIELD or Practice Field.

Event Rules Manual

The official *FIRST* Robotics Competition Event Rules Manual may be found at:

<https://www.firstinspires.org/resource-library/frc/event-experience>

Contact Us

Please note: The schedule, activities, team participation, and items in this handbook are subject to change. All times are estimated based on flow of rounds. We'll do our best to keep you informed of changes or additions. Please contact Daphne Frownfelter, Regional Director, with any questions or concerns at dfrownfelter@firstinspires.org, 610-401-4310.